

# INSTALLATION INSTRUCTIONS

Accessory  
**CHROME REAR LOWER COWL**  
 P/N 08F81-MCA-100F

Application  
**GL1800**

Publications No.  
 Issue Date  
**October 2000**

## PARTS LIST

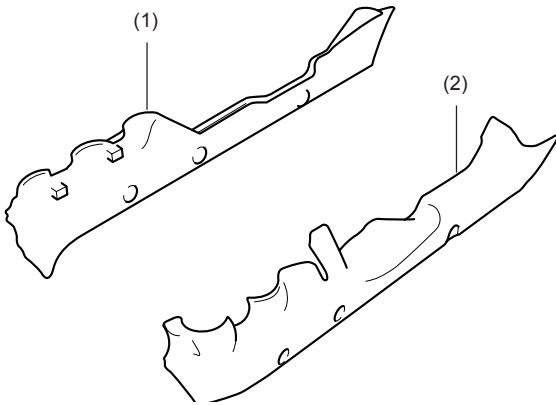

No.	Description	Q'ty
(1)	Right chrome rear lower cowl	1
(2)	Left chrome rear lower cowl	1

## INSTALLATION

### NOTE:

- To prevent scalding, allow the engine and cooling system to cool before installing the radiator cowl.

- Remove the front lower cowl as described in the Service Manual.

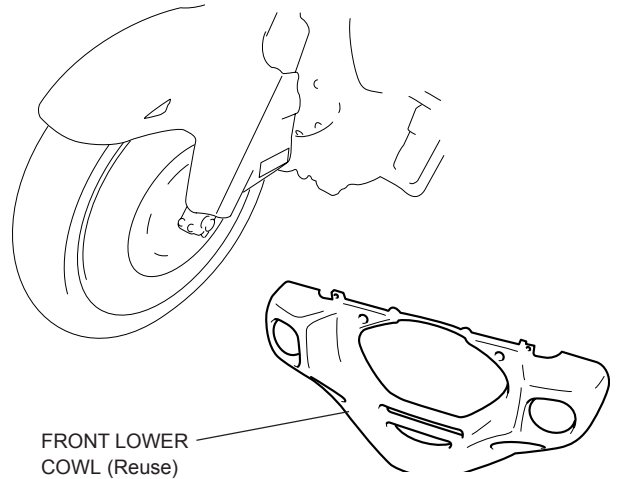

- Remove the left rear lower cowl.

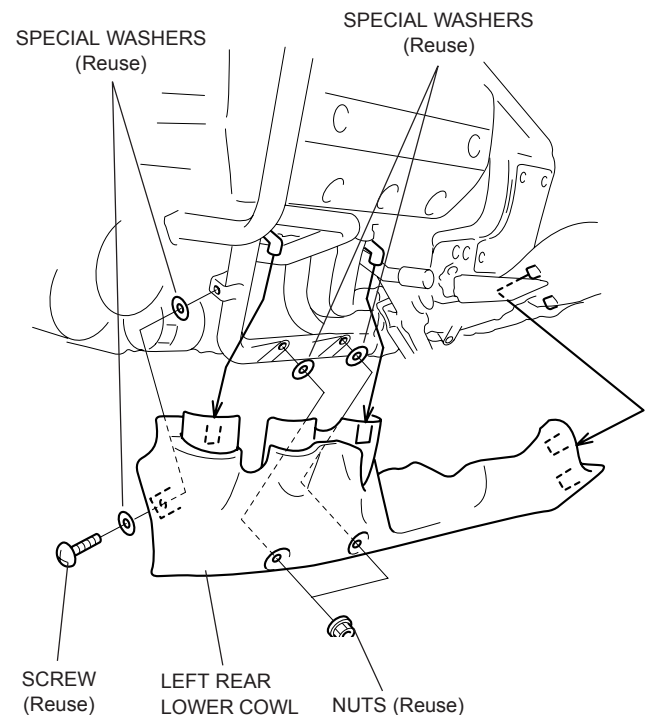

3. Remove the left inner guard and rubber from the left rear lower cowl.

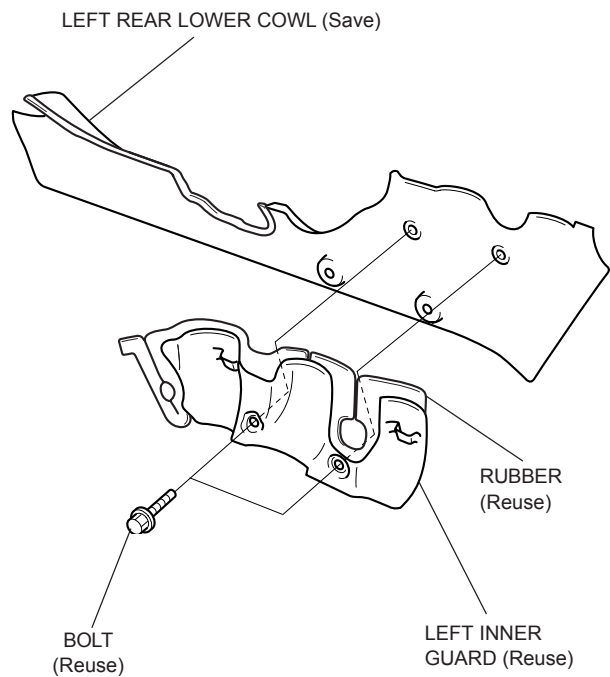

4. Reinstall the left inner guard and rubber on the left chrome rear lower cowl in the reverse order of removal.
5. Reinstall the left chrome rear lower cowl in the reverse order of removal.
6. Repeat on the right chrome rear lower cowl.

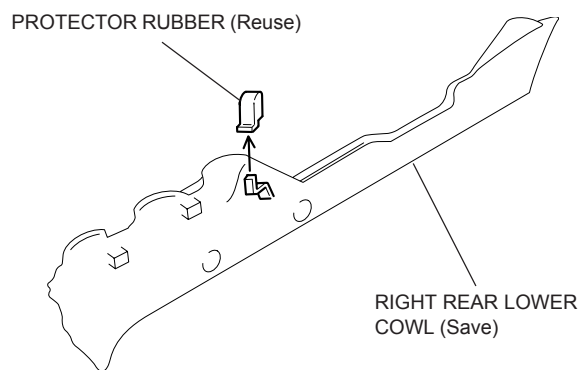

7. Reinstall the front lower cowl.